

Raffle Drawing

Custom Dog Houses



Enter to Win! Tickets are \$5 Each or Five for \$20.

I would like to purchase _____ raffle tickets. Amount Enclosed: \$ _____
 You choose which house(s) to enter for! Please enter my raffle tickets in house number(s):
 _____ 1 Malibu _____ 2 Junkyard Dawg _____ 3 Bähühaus _____ 4 Pooch Perch

The raffle for these amazing custom dog houses will be drawn at Barktoberfest on Sunday, October 3, 2010. You do not need to present to win.

Name: _____ Business: _____

Address: _____ City/St/Zip: _____

Phone: _____ Fax: _____ Email: _____

Payment Method: Check Cash Visa/Mastercard

Credit Card # _____ Exp. Date : _____

Signature : _____ 3-Dig Code: _____

Mail to: Placer SPCA
 150 Corporation Yard Road
 Roseville, CA 95678

**You can also purchase raffle tickets at the Placer SPCA
 or by phone at (916) 782-7722 x. 106 or (530) 885-7387 x. 106.**

Placer County's Companion Animal Welfare Experts – Where Your Donations Stay Local

916.782.7722 or 530.885.7387, Ext. 102
 funddevelopment@placerspca.org

150 Corporation Yard Road
 Roseville, CA 95678
 Fax: 916.782.8655

www.placerspca.org

Preview the Custom Dog Houses in Person at Placer County Locations!
 Please visit www.placerspca.org/barktoberfest for details.

Special Thanks to the architects, builders, and contributors for creating and donating the custom dog houses. All proceeds directly benefit Placer SPCA.
 The raffle drawing will be held at Barktoberfest on Sunday, October 3.
 You do not need to be present to win.

1. Malibu

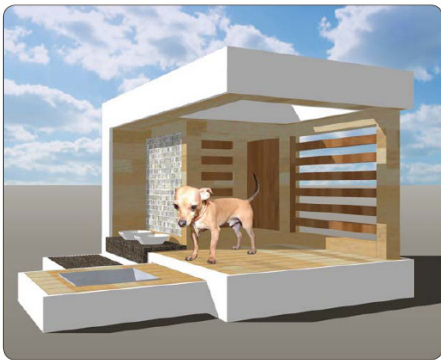

PROJECT TEAM
 BUILDER:
 Carter Kelly-Placerville CA
 DESIGNER:
 HGA Architects-Roseville CA
 CONTRIBUTORS:

2. Junkyard Dawg



PROJECT TEAM
 BUILDER:
 Descor Builders-Rancho Cordova CA
 DESIGNER:
 MAS/Mojica Architecture Studio-Roseville CA
 CONTRIBUTORS:
 CVC Concrete
 Prime Mechanical

3. Bauhäuser



PROJECT TEAM
 BUILDER:
 Sierra View Company-Granite Bay CA
 DESIGNER:
 Williams + Paddon Architects-Roseville CA
 CONTRIBUTORS:
 Sondad Iron Works- Roseville
 Complete Millwork Services, Inc.
 Carson City NV

4. Pooch Perch



PROJECT TEAM
 BUILDER:
 Landmark Construction-Loomis CA
 DESIGNER:
 LPA Inc.-Roseville CA
 CONTRIBUTORS:
 Del Paso Pipe and Steel
 McCumber Glass
 Sacramento Building Products
 Mondo
 Moule's Foothill Glass
 Home Depot-Roseville, Sunrise Avenue Store

Join us for Barktoberfest!

Barks, Brats, and Bids Saturday, October 2 ~ 6:00 pm – 9:00 pm
Fun, FREE Family Festival Sunday, October 3 ~ 9:00 am – 2:00 pm
 At 7501 Foothills Blvd., Roseville

www.placerspca.org/barktoberfest