



For the Love...

PLACER SPCA

Society for the Prevention of Cruelty to Animals



CompanionConnection

Winter 2010

Coming January 2011...

The Pet Adoption & Resource Center in Auburn, operated by Placer SPCA

To be located on Grass Valley Highway near Luther Road, the Pet Adoption and Resource Center will house 30+ cats and two or more dogs, and include an education room and dog training area. The cat and dog rooms will be modern spaces offering the residents more area to play and explore than traditional kennels.

The Placer SPCA was founded in Auburn in 1973 by a group of volunteers dedicated to helping homeless animals in Placer County. In 1995, Placer SPCA moved to the current Companion Animal Care Center located in Roseville. Local companion animal welfare experts, Placer SPCA has continuously offered programs and services throughout Placer County, and we now eagerly look forward to operating a new facility in our hometown.

The lease has been secured and construction will soon begin to prepare for our January opening. Volunteers will be needed!

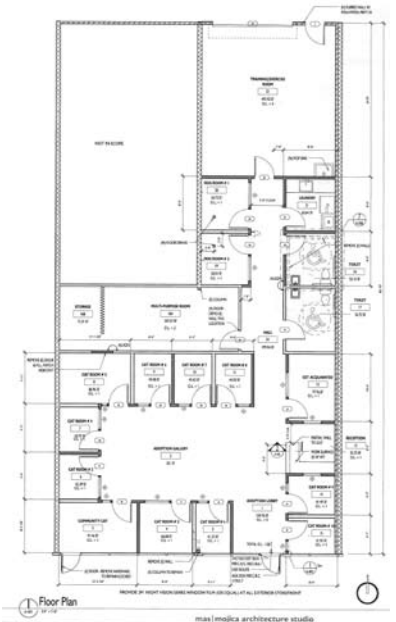

Plans provided by Mas Mojica Architecture Studio

Naming Opportunities

Act now for permanent naming rights for the Pet Adoption and Resource Center in Auburn, operated by Placer SPCA.

Name on Building	\$100,000
Lobby/Adoption Gallery	\$25,000
<i>Reserved by: The Harry Rosenberry Foundation</i>	
Education Room	\$25,000
Training Room	\$25,000
Community Cat Room	\$20,000
Dog Rooms	\$15,000/ea
Cat Rooms	\$10,000/ea
Get Acquainted Room	\$5,000
Paw Plaque	\$1,000

Naming opportunities \$5,000 and over may be paid in installments over 24 months.

If you are interested in a naming opportunity listed above, please contact the Development Department at (916) 782-7722 x. 102, (530) 885-7387 x. 102, or fundevelopment@placerspca.org.

be an angel

Hi, my name is Samantha. I am an eight-year-old German Shepherd who arrived as a stray. After arriving the staff ran some blood work and determined that I have heartworm disease. I am in need of treatment to rid me of the disease. After testing and the six weeks of medication I need, the total estimated cost for my medical care is \$414.62. Do you feel it in your heart to help a special little girl such as myself?

For more about our programs and services:

(916) 782-SPCA (7722)
(530) 885-PETS (7387)
www.placerspca.org

- Guardian Angel Fund ext. 102
- Customer Care ext. 100
- Spay & Neuter Assistance Program (SNAP) ext. 201
- Behavior Helpline ext. 258
- Humane Education ext. 253
- Volunteer Program ext. 104
- Fund Development ext. 102
- Foster Care Program ... ext. 111

Placer SPCA Thrift Store
(916) 782-2434
placerspca.org/thrift

... of a Lifetime



Joy, a four-year-old rat terrier mix, needed blood tests at a cost of \$47.



Placer Society for the Prevention of Cruelty to Animals
 150 Corporation Yard Road
 Roseville, CA 95678
 (916) 782-7722 ❖ (530) 885-7387
www.placerspca.org

Center Hours
 Tue & Fri-Sun: 11:00 a.m. - 4:00 p.m.
 Wed & Thurs: 2:00 - 7:00 p.m.
 Closed Mon & holidays

- Board of Directors**
- Jeff Dutra, President
RICARDO BEVERLY HILLS,
PACIFIC WEST MARKETING
 - Robin Trimble, President Elect
ROCKLIN CHAMBER OF COMMERCE
 - Robert Flautt, Past President
FOLSOM LAKE BANK
 - E. Howard Rudd, Treasurer
INTEGRAL FINANCIAL MANAGEMENT
 - Marcus Lo Duca, Secretary
LO DUCA & AVDIS, LLP
 - Larry Payne, Director at Large
PAYNE ASSOCIATES, LLC
 - Sharon Brown
BRIGHT BEGINNINGS WELCOMING SERVICE
 - Kent Liebman
RETIRED, INTEL CORPORATION
 - Edward Mojica
MAS MOJICA ARCHITECTURE STUDIO
 - Marilyn Festersen
MARILYN EISNER FESTERSEN INSURANCE
 - Gail Reinke
RETIRED, NEC ELECTRONICS AMERICA, INC.
 - Bill Fastiggi, DVM
SUNRISE BOULEVARD ANIMAL HOSPITAL
 - David Kaiser
 - Curtiss Johnson
ENTERCOM RADIO (96.9 THE EAGLE)
 - Barbara Nelson
SUTTER ROSEVILLE MEDICAL CENTER
 - Chris Mann
MANN, URRUTIA & NELSON CPAS
 - Mark Davis
SIERRA VIEW CONSTRUCTION
 - John Mason
GURNEE & DANIELS LLP
 - Jim Gray
ROSEVILLE CITY COUNCIL MEMBER
 - Tracey Prim, Board Recorder

- Administrative Personnel**
- Leilani Vierra, *Chief Executive Officer*
 - Cory Bertoglio, *Volunteer Program Manager*
 - Laura Birdsall, *Animal Care Supervisor*
 - Matt Green, *Director of Operations*
 - Crystalaura Jackson, *Outreach Program Mgr*
 - Debbie Lewis, *Executive Assistant*
 - Tiffany Smith, *Admissions/Adoptions Manager*
 - Susan Willson, *Development Director*

thanks to our generous supporters

Memorials & Honorariums (August 18 – October 7, 2010)

In Loving Memory of... (PEOPLE)

Carol Jean Arends
Shirley & Donna
Cirimele

Heather Powell Safreid
Mary Lee Welch

Richard Howard
Sandra Banks
Daniel Kunz

Noreen Sorg
Diane & Robert
Hendrix
Allen & Silvana
Sjostrand
Maria E. Tebbetts,
M.D. & Sandy
Pitts

Dianne Gershuny
Roseville Police
Dept.

Bernice Sorg
Carolyn & Edmund
Pecinovsky

Kathy Pullin
Frank & Joan Rose

Amy Able
Patricia & Wayne
Feiling

Betty Lou Young
Patricia Anderson

In Loving Memory of... (PETS)

Wing Nut
Beverly Myers

In Honor of...

Shelly Mekeel's Birthday
Chuck & Susan
Nelson

Pam Trice
Sherry Edgar

Shirlee Queirolo
Doug Callow

Clancey
Dawn Gould

Glenda McMillan
Audrey & Robert
Risberg

We appreciate all memorial and honorarium gifts. Gifts of \$50 or more are acknowledged in the newsletter.



Donations are accepted securely online at www.placerspca.org

Placer SPCA, your local companion animal welfare experts.

We are a private nonprofit organization not affiliated with any other entity, Tax ID# 94-2607682. We receive no donations through the ASPCA or HSUS.



SANTA CLAWS

November 6 & 7
 11:00 am - 4:00 pm

Bring the entire family for fun holiday photos!

Affordable photos start at just \$10.00.

Purr-fect for holiday cards!

All proceeds benefit the Placer SPCA.

Santa Claws is coming to Placer SPCA, 150 Corporation Yard Road, Roseville. No appointment necessary. Please have all dogs on leash and all cats in carriers.

Come to the Placer SPCA Holiday Open House

Thursday, December 2
5:30 - 8:00 p.m.

Here at our Companion Animal Care Center
 150 Corporation Yard Road
 Roseville, CA 95678

Enjoy food, tours of the center, a silent auction, raffle, and lots of good cheer! You can even bring a gift for the animals for our holiday tree. Visit placerspca.org/wish for a list of items needed.

No RSVP required, come one, come all!



Estate Planning Workshop

Thursday, Nov. 11
12:00 pm

Reserve your spot for
this free workshop:

(916) 782-7722 x. 102
(530) 885-7387 x. 102

funddevelopment@
placerspca.org

Thank you, Paw Club sponsors!

Gold Paw Donor Club (\$10,000+ SPONSORS)

Patricia & George Locke

Ruth M. Welch

Sally Jo Rapstad

Gene & Eve Rutkowski

Silver Paw Donor Club (\$5,000+ SPONSORS)

Ayrshire Farm - Sandy Lerner

Mark & Lilly Gillam

Wells Fargo Foundation

SureWest Foundation

The Harry Rosenberry Foundation

Bronze Paw Donor Club (\$1,000+ SPONSORS)

Grant Macleod

Lynn Merrick

Jon & Gabrielle Self

George & Marilyn Rose

John & Darleen Feller

Auburn 49er Lions Club

Dwelle Family Foundation

Richard SeEVERS & Associates

Bonnie Torres

Mary Lee Welch

Elinor Carpenter - In memory of Sasha

Sheila Cardno, LPL Financial

Janet Clark

The Laursen Family Fund

Simplified Design Solutions, LLC

Rhoades Family Foundation

Mann, Urrutia & Nelson, CPAs

Cindy Dean

Shari Jennings

Mary & Glenn Meyers

Ian & N'Gina Kavookjian

Sheila & William Owen

Jim & Trish Schreiber

Karen & Colin Grahl

Westlake, Grahl & Glover

Roy Hashimoto & Kelly Torikai

Sharon Musso

Jack & Maryann Spiegelman

The Buzz Oates Group of Companies

Kent & Jeannette Liebman

Leroy M. Rey

Anne & Len Hauber

In Memory of Jeanette Barra-Salas

Reenas Electronics America, Inc.

Al Johnson Consulting, LLC

Ruth & Don Mills

Lera Rogers

You can help the animals!

There are many ways to support the Placer SPCA

Become a Corporate Partner: Give locally to strengthen our community!

Donate Your Vehicle: Tax deductible and easy!

Become a Kennel Sponsor: We'll display a plaque for one year in an Adoption Room and you will receive recognition in *Companion Connection*.

Join the Paw Club: Bronze \$1,000, Silver \$5,000, Gold \$10,000: Permanent recognition in the Placer SPCA lobby and recognition for one year in *Companion Connection*.

Consider a Planned Gift: Leave a legacy for the animals while gaining tax benefits for your estate.

Donate new or gently used items to the Placer SPCA Thrift Store: Donations to the Thrift Store are tax-deductible to the extent allowed by law.

Make a Gift in Any Amount: All donations make a difference!

For more information about these and other creative ways to give, visit placerspca.org and click on the Support Us menu, or contact the Development Department at (916) 782-7722 x. 102, (530) 885-7387 x. 102, or funddevelopment@placerspca.org.



Photo: Stacyc Ruiz

PLACER SPCA THRIFT STORE SHOP DONATE VOLUNTEER

931 Washington Blvd., Ste. 107, Roseville
At Washington & Junction

(916) 782-2434 placerspca.org/thrift

Store Hours: Tue - Sun 10:00 a.m. - 5:00 p.m.

Donations: Tue - Sun 10:00 a.m. - 4:00 p.m.

Volunteers Needed! Please contact pspcathrift@gmail.com or call (916) 782-2434.

Thank you to our Kennel Sponsors!

Your donations help keep our animals warm, dry, and safe.

Dog Kennel Sponsors

**In memory of our dear sister and aunt Cathy
Gunderson who rescued miniature schnauzers.
The Manitta & Potter families
Carl & Michele Manitta**

Animals make our lives complete.

Laura & James Putnam, Comprehensive
Consulting Corp.

Cat Suite Sponsors

**In Memory of Roxi & Oscar
Shari Jennings**

Cat & Rabbit Kennel Sponsors

**In Memory of Precious Squeaker
Jack & Gale Wright**

**In Loving Memory of Oscar
Shari Jennings**

**In Loving Memory of Roxi
Shari Jennings**

**In Loving Memory of Whit, Andy and Peach
Karen & Colin Grahl**

**Ja ta lubim, Bapka
Karen & Colin Grahl**



Interested in becoming a Kennel Sponsor? **Development Department:**
(916) 782-7722 or (530) 885-7387, ext. 102 funddevelopment@placerspca.org

Circle of Hope Legacy Society

Members of the Circle of Hope Legacy Society have included Placer SPCA in their will, trust, or estate, and have notified us of their intentions.

Those listed have given permission for public recognition.

The Smith Family Trust/Robert T.G. and Claudia K. Smith

Marilyn Kennedy

LeeAnn & Lonnie Dickson

Bill & Nancie Radakovitz

Patricia M. Anderson

Mary & Dave Terrell

Charlene Michelson

Jack & Gale Wright



In Memory and Gratitude

Gene & Eve Rutkowski, pictured with LaBelle Tinker, left a generous bequest to Placer SPCA.

We came...

In early October, we held our first ever Barktoberfest, which we referred to as our Festival for Canines and Their Well-Behaved Human Companions.



What fun! On Saturday, October 2 we held Barks, Brats & Bids, an elegant evening of wine and food tasting with a twist: dogs were welcome!

We saw...



On Sunday, October 3, dogs and their owners flocked to the grounds of Renesas Electronics America for the free Barktoberfest family festival. For a first year event the attendance was beyond our wildest dreams!

We had a GREAT time!



Event photos courtesy of Todd Olson, Image Outfitters Photography.



We would like to give a special thanks to all the sponsors, vendors, and attendees! Just wait 'til next year!

2010 Barktoberfest Sponsors



Great Dane Sponsor
The Eagle 96.9 FM

Weimaraner Sponsors
SureWest Foundation
Folsom Lake Bank

Schnauzer Sponsors
Mann, Urrutia & Nelson CPAs
Westlake, Grahl & Glover
The Buzz Oates Group of Companies
Renasas Electronics America
Al Johnson Consulting
PG & E
Gold Country Media



For a complete list of sponsors, please visit placerspca.org/barktoberfest.

THANK YOU 2010 Corporate Partners!

Placer SPCA's Corporate Partnership Program is an investment in the Placer SPCA and the community. Corporate Partners pledge year-long support for the programs, services, and events of the Placer SPCA.

SILVER PARTNER
SureWest Foundation

BRONZE PARTNERS
Mann, Urrutia & Nelson, CPAs
Westlake, Grahl & Glover
Al Johnson Consulting, LLC
The Buzz Oates Group of Companies
Renasas Electronics America

Interested in Corporate Partnership? Development Department:
(916) 782-7722, ext. 102 or (530) 885-7387, ext. 102
funddevelopment@placerspca.org